

MOBILE COUNTY, ALABAMA

PAY-AS-YOU-GO-PROGRAM
PROJECT NO. MCR-2018-202
CITY OF SEMMES STREETS

KUSHLA-MCLEOD ROAD AND ROSEMARY ROAD
RESTORATION, RESURFACING AND REHABILITATION

CITY OF SEMMES CITY COUNCIL
TERRY PLATT
LEE LAWSHE
HOWARD SMITH
CHARLES WATTS
LAWRENCE WEBB

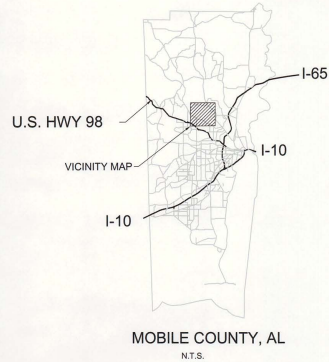

MOBILE COUNTY, AL
N.T.S.

INDEX OF DRAWINGS

SHEET #	TITLE
SHEET C01	COVER SHEET
SHEET C02	LEGEND AND TYPICAL SECTIONS
SHEET C03	SUMMARY OF QUANTITIES
SHEET C04-C06	ROSEMARY AND KUSHLA-MCLEOD ROAD PLAN SHEETS
SHEET C07	TRAFFIC CONTROL PLAN
SHEET C08	TRAFFIC CONTROL DETAILS

INDEX	DWG. NO.	DESCRIPTION
905	LCS-107	DETAILS SHOWING REQUIREMENTS FOR LIGHTING CONSTRUCTION SIGNS
1045	TCD-100	DETAILS FOR TRAFFIC CHANNELIZATION DEVICES
1048	TCM-703	PAVEMENT LEGENDS AND MARKINGS DETAILS
1049	TCM-703	PAVEMENT LEGENDS AND MARKINGS DETAILS
1328	SHS-28	STANDARD HIGHWAY SIGNS
1329	SHS-29	STANDARD HIGHWAY SIGNS

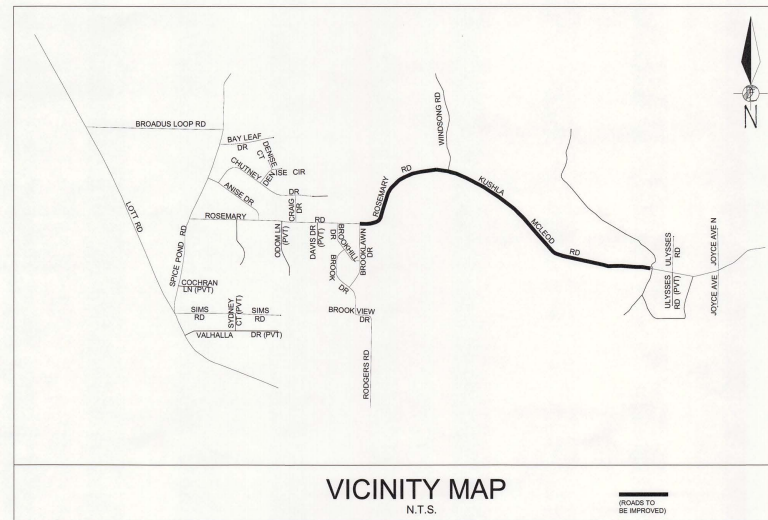

VICINITY MAP
N.T.S.

ROSEMARY ROAD		KUSHLA-MCLEOD ROAD	
ADT	950	ADT	950
% TRUCKS	N/A	% TRUCKS	N/A
FUNCTIONAL CLASSIFICATION	Major Local	FUNCTIONAL CLASSIFICATION	Major Local
POSTED SPEED	35 M.P.H.	POSTED SPEED	35 M.P.H.

811
Know what's below.
Call before you dig.

Dig! Safety. Alabama Call

UNDERGROUND UTILITY NOTE
UNDERGROUND UTILITY LOCATIONS SHOWN ARE APPROXIMATE AND ARE BASED ON INFORMATION PROVIDED. THE UTILITIES SHOWN MAY NOT BE A COMPLETE REPRESENTATION OF ALL UTILITY LINES IN THE PROJECT AREA. CONTRACTOR IS REQUIRED TO CONTACT ALABAMA ONE CALL PRIOR TO DIGGING 1-800-282-8633 (WWW.AL.CALL.COM). OTHER UTILITIES (INCLUDING PRIVATE UTILITIES OUTSIDE A PUBLIC RIGHT-OF-WAY) THAT DO NOT PARTICIPATE IN THE ALABAMA ONE CALL LINE LOCATION SERVICE NEED TO BE CONTACTED INDIVIDUALLY AND/OR PHYSICALLY LOCATED BY THE CONTRACTOR.

UTILITY OWNERS		
NATURAL GAS Sopris Mr. Jacob Huffstader 2828 Dauphin Street Mobile, AL 36688 (251)450-4624 (251)450-4758 (fax) jacob.huffstader@gasnetwork.com	GAS South Alabama Utilities David Morse 4800 McCarty Rd. Semmes, AL 36575 Business: (251)948-4316 Ext. 229 Fax: (251)945-0950 dmorse@southalabamautilities.net	POWER Alabama Power Company David Richardson 150 St. Joseph Street P.O. Box 2247 Mobile, AL 36602 Business: (251)694-2450 Fax: (251)694-2449 drrichard@alpower.com
TELEPHONE AT&T Eddie Montgomery 2155 Old Shell Rd. Mobile, AL 36607 Business: (251)470-5660 Cell: (251)924-0197 Fax: (251)471-8267 em5555@att.com	WATER South Alabama Utilities David Morse 4800 McCarty Rd. Semmes, AL 36575 Business: (251)948-4316 Ext. 229 Fax: (251)945-0950 dmorse@southalabamautilities.net	CABLE Comcast Cablevision Donnie Little 3248 Springhill Ave. Mobile, AL 36607 Business: (251)695-6906 Cell: (251)695-6334 donnie_little@cable.comcast.com

LENGTH OF PROJECT SUMMARY:			
KUSHLA-MCLEOD ROAD	6250	LINEAR FEET	1.18 MILES
ROSEMARY ROAD	3500	LINEAR FEET	0.67 MILES

FOR REFERENCE ONLY August 8, 2019
NOT FOR BIDDING
CONTRACTORS MUST PURCHASE PLANS FROM AND REGISTER WITH THE ENGINEER
SUBMITTED BY: AVALISHA L FISHER, P.E., ALABAMA REG. NO. 22182
ADMINISTRATIVE APPROVAL BY: DAVID BAKER, MAYOR OF THE CITY OF SEMMES

NOTE: THIS PROJECT SHALL BE CONSTRUCTED IN ACCORDANCE WITH ALABAMA DEPARTMENT OF TRANSPORTATION STANDARD SPECIFICATIONS FOR HIGHWAY CONSTRUCTION 2018 EDITION.

PLANS NOT VALID UNLESS THEY BEAR A COLOR SIGNATURE OF AN EXPOSED SEAL. PLANS ARE NOT ISSUED FOR CONSTRUCTION UNLESS THE REVISION IS A NUMERAL.

REV	DATE	BY	CHKD	DESCRIPTION
D	12/22/19	ALF	ALF	ISSUED FOR BIDS
C	07/12/2019	BN	ALF	TRUCK SIGNING
B	04/23/2019	BN	ALF	BID SUBMITTAL FOR REVIEW
A	03/07/2019	BN	ALF	BID SUBMITTAL FOR REVIEW

MOBILE COUNTY COMMISSION
MERCERIA L. LUDGOOD
CONNIE HUDSON
JERRY CARL



Driven Engineering, Inc.
8005 Morris Hill Road
Semmes, AL 36575
(251) 645-4011 Fax
www.driveneengineering.com



FILE:

MCR-2018-202
CITY OF SEMMES STREETS
COVER SHEET

DATE	SCALE	AS SHOWN
03/22/2019	AS SHOWN	
ISSUED BY:	PREPARED BY:	PRINTED BY:
BN	ALF	ALF
DRAWING NUMBER:	SHEET NUMBER:	REVISION:
C01	8	D

GENERAL NOTES:

- STANDARD SPECIFICATIONS FOR STREETS AND DRAINAGE. REFERENCE IS MADE TO THE ALABAMA DEPARTMENT OF TRANSPORTATION STANDARD SPECIFICATIONS FOR HIGHWAY CONSTRUCTION, 2018 EDITION. ALL PROVISIONS OF SAID STANDARD SPECIFICATIONS SHALL APPLY TO THIS CONTRACT AND ARE HEREBY MADE A PART OF THIS CONTRACT, EXCEPT WHEN THE PROVISIONS HEREON OR THE PLANS ARE CLEARLY IN CONFLICT WITH THE PROVISIONS OF SAID STANDARD SPECIFICATIONS, THE PROVISIONS HEREON AND THE PLANS SHALL GOVERN.
- THE CONTRACTOR IS TO FIELD VERIFY ALL DIMENSIONS, ELEVATIONS, AND CONDITIONS PRIOR TO CONSTRUCTION OR FABRICATION.
- THE CIVIL DRAWINGS SHALL BE USED IN CONCORDANCE WITH THE DRAWINGS OF ALL OTHER DISCIPLINES AND ANY APPLICABLE SPECIFICATIONS. CONTRACTOR IS DIRECTED TO NOTIFY THE ENGINEER OF RECORD IMMEDIATELY IF ANY CONFLICT IS FOUND BETWEEN THE CIVIL PLANS AND THE PLANS OF OTHER DISCIPLINES.
- WHERE A DETAIL IS SHOWN FOR ONE CONDITION, IT SHALL APPLY FOR ALL LIKE OR SIMILAR CONDITIONS EVEN THOUGH NOT SPECIFICALLY CALLED FOR ON THE DRAWINGS.
- ALL UNPAVED AREAS THAT HAVE BEEN GRADED, CUT, OR FILLED SHALL BE TREATED WITH A SUITABLE COMMERCIAL FERTILIZER IN ACCORDANCE WITH ALABAMA DEPARTMENT OF TRANSPORTATION 2018 STANDARD SPECIFICATIONS, AND BLENDED WITH A METRIC TO SET THE PLANTING ZONE (602.0) AND DATE OF PLANTING (606.0) PER ALABAMA DEPARTMENT OF TRANSPORTATION 2018 STANDARD SPECIFICATIONS. A FIRM STAND OF PERMANENT GRASS WILL BE REQUIRED.
- ALL CONCRETE USED ON THE PROJECT SHALL BE 3000 PSI MINIMUM COMPRESSIVE STRENGTH REQUIRED IN 28 DAYS, UNLESS SPECIFICATIONS REQUIRE CONCRETE OF GREATER STRENGTH.
- UNDERGROUND UTILITY LOCATIONS SHOWN ARE APPROXIMATE AND ARE BASED ON INFORMATION PROVIDED. THE UTILITIES SHOWN MAY NOT BE A COMPLETE REPRESENTATION OF ALL UTILITY LINES IN THE PROJECT AREA. CONTRACTOR IS REQUIRED TO CONTACT ALABAMA ONE CALL PRIOR TO DIGGING (1-800-292-8525) (WWW.ALONECALL.COM). OTHER UTILITIES (NON-CONCRETE OR METRIC) ARE THE PROPERTY OF A PUBLIC UTILITY OR AGENCY THAT DO NOT PARTICIPATE IN THE ALABAMA ONE CALL LINE LOCATION SERVICE NEED TO BE CONTACTED INDIVIDUALLY AND/OR PHYSICALLY LOCATED BY THE CONTRACTOR.
- SUB-GRADE AND BASE SHALL BE COMPACTED TO THE REQUIREMENTS OF ALABAMA DEPARTMENT OF TRANSPORTATION STANDARD SPECIFICATIONS, UNLESS OTHERWISE NOTED.
- THE CONTRACTOR WILL BE RESPONSIBLE FOR PROPER COMPACTION ON ANY AND ALL UTILITY DITCHES.
- ALL FILL AND EMBANKMENT CONSTRUCTION SHALL BE COMPACTED AS REQUIRED IN LAYERS NOT TO EXCEED 4".
- ALL SUITABLE EXCESS UNCLASSIFIED EXCAVATION IS TO BE UTILIZED FOR CONSTRUCTION OF EMBANKMENTS AND SLOPES NOT DIRECTLY UNDER THE TRAVEL WAY OR PARKING AREAS PRIOR TO USING ANY OFF-SITE BORROW EXCAVATION. AFTER CONSTRUCTION OF SUCH AREAS EXCEEDING EXCESS EXCAVATION SHALL BE SPREAD AS DIRECTED BY THE ENGINEER OR AT THE ENGINEER'S DIRECTION, HAULED FROM THE SITE AT NO ADDITIONAL PAYMENT.
- ALL SEDIMENT CONTROL DEVICES SHALL BE CONSTRUCTED AND FULLY FUNCTIONING PRIOR TO ANY OTHER CONSTRUCTION OR GRADING ACTIVITY.
- ALL SLOPES MUST BE STABILIZED AS SOON AS POSSIBLE TO PREVENT EXCESSIVE EROSION.
- THE SITE IS LOCATED IN SEC. 1, T-3-S, R-3-W, AND SEC. 4, T-3-S, R-2-W, MOBILE COUNTY, ALABAMA.
- PRELIMINARY SOILS TESTING AND ON-SITE CONSTRUCTION MATERIALS TESTING IS TO BE PERFORMED BY AN INDEPENDENT GEOTECHNICAL ENGINEER. THE GEOTECHNICAL ENGINEER FOR THIS PROJECT IS P. J. WILSON.
- ALL MATERIALS SHALL BE NEW UNLESS USED OR SALVAGED MATERIALS ARE AUTHORIZED BY THE OWNER.
- HIGH INTENSITY LIGHTING FACILITIES SHALL BE SO ARRANGED THAT THE SOURCE OF ANY LIGHT IS CONCEALED FROM PUBLIC VIEW AND FROM ADJACENT RESIDENTIAL PROPERTY AND DOES NOT INTERFERE WITH TRAFFIC.
- CONTRACTOR IS PROHIBITED FROM DISTURBING TREE AREAS OUTSIDE THE CONSTRUCTION LIMITS SHOWN ON THE PLANS WITHOUT PRIOR APPROVAL FROM THE ENGINEER. STANDING AREAS OUTSIDE THE CONSTRUCTION LIMITS, FIELDS OF CRIP, AND OTHER BARE AREAS ARE TO BE COVERED AS DIRECTED BY THE ENGINEER. ANY AREAS DISTURBED OUTSIDE THE CONSTRUCTION LIMITS WILL BE REPAIRED AND COVERED WITH A FIRM STAND OF GRASS BEFORE FINAL PAYMENT AND FINAL ACCEPTANCE OF THE PROJECT AT NO ADDITIONAL COST TO THE OWNER. IF GRASS WILL NOT GROW ON THE SUBJECT AREA DUE TO POOR WEATHER CONDITIONS, THE CONTRACTOR AGREES TO PLACE SOIL ON THE AREA TO PREVENT EXCESS BARE AREAS FROM CONTRIBUTING SEDIMENT EROSION TO THE SITE THAT ARE UNDER CONSTRUCTION.
- CONTRACTOR IS REQUIRED TO USE "BEST MANAGEMENT PRACTICES" COMPLIANT WITH THE ALABAMA HANDBOOK FOR EROSION CONTROL AND STORMWATER MANAGEMENT ON CONSTRUCTION SITES AND URBAN ALABAMA AND THE WATER CONSERVATION COMMITTEE, MONTEAGUE, ALABAMA, VOLUMES 1 & 2, CURRENT EDITION, TO PREVENT SEDIMENT LOADS FROM STORED WATER RUNOFF FROM EXISTING MATERIALS FROM LEAVING THE CONSTRUCTION SITE.
- ALL MATERIALS AND WORKMANSHIP WITHIN A STATE OR COUNTY RIGHT-OF-WAY SHALL CONFORM TO THE ALABAMA DEPARTMENT OF TRANSPORTATION STANDARD SPECIFICATIONS FOR HIGHWAY CONSTRUCTION, 2018 EDITION.
- CONTRACTOR IS REQUIRED TO CONTACT MR. NEAL HOWARD MOBILE COUNTY PUBLIC WORKS ENGINEERING MANAGER AT (251) 574-8089 TO DISCUSS THE CONDITIONS OF THE COUNTY MAINTAINED ROAD LEADING TO THE CONSTRUCTION SITE AND TO OBTAIN ANY WORK WITH THE COUNTY MAINTAINED RIGHT-OF-WAY.
- ALL CONCRETE PIPE TO BE PLACED WITHIN ANY MOBILE COUNTY RIGHT-OF-WAY SHALL HAVE A MOBILE COUNTY CERTIFICATION DOCUMENT AS WELL AS A "KICK-UP" STAMP ON THE PIPE. THE CERTIFICATION IS IDENTICAL TO THE BMT-72 THAT IS REQUIRED BY ALDIT. WHOEVER ORDERS PIPE FOR THIS PROJECT SHOULD LET THE SUPPLIER KNOW AT THE TIME OF ORDERING THAT IT IS A MOBILE COUNTY JOB.
- FILTER BLANKET USED WITH RIPA SHALL BE A NON-WOVEN GEOTEXTILE TYPE GTOEX 801 OR ENGINEER APPROVED EQUIVALENT.
- ALL PIPE END TREATMENTS SHALL INCLUDE A 10E WALL AT LEAST 1 SHEET DEEP AND 8 INCHES THICK UNLESS CONNECTED TO A CONCRETE DITCH SECTION OR A BEVELED END SECTION IS SPECIFIED.
- THERE SHALL BE NO ADDITIONAL PAYMENT FOR REVELED END SECTIONS AS THEY ARE A SUBSIDIARY OBLIGATION OF ITEM 530 AND 535. ITEMS 530 AND 535 SHALL BE MEASURED FROM INVERT TO INVERT.
- LINEAR FOOTAGE OF STORM DRAIN PIPES SHOWN ON PLAN SHEETS INCLUDES REVELED END SECTIONS, IF APPLICABLE.
- THE CONTRACTOR SHALL BE REQUIRED TO NOTIFY THE GEOTECHNICAL ENGINEERING LABORATORY OF HIS WORKING SCHEDULE IN ORDER THAT THE PROPER SAMPLE MAY BE OBTAINED AND TEST MADE.
- IF EXISTING PIPES THAT REQUIRE EXTENSION ARE BROKEN BEFORE CONSTRUCTION BEGINS AND THE ENGINEER DETERMINES AN INCREMENT BASED THAT A CONCRETE COLLAR IS REQUIRED, THE COLLAR WILL BE CONSTRUCTED AS DETAIL IN THE ALABAMA DEPARTMENT OF TRANSPORTATION SPECIAL AND STANDARD DRAWINGS. CONTRACTOR'S EDITION, AND SHALL BE PAID FOR AS ITEM 530. A MINOR STRUCTURE CONCRETE INCLUDING REINFORCEMENT AT THE CONTRACT BID PRICE FOR CONCRETE SHALL BE PAID BY THE CONTRACTOR.
- TREES THAT ARE TO BE PROTECTED AND PRESERVED ARE INDICATED ON THE PLAN OR AS DIRECTED BY THE ENGINEER OR THE ENGINEER'S SUPERVISOR SHALL BE PROTECTED BY THE CONTRACTOR DURING CONSTRUCTION. THE CONTRACTOR IS DIRECTED TO EXERCISE EXTREME CAUTION WHEN WORKING NEAR THESE TREES. NO VIBRATING OR HEAVY EQUIPMENT SHALL BE PARKED UNDER THE CANOPY OF THESE TREES. WHEN SUCH EQUIPMENT IS PLACED UNDER THE ROOT ZONE OF THESE TREES, ROOTS ARE TO BE LAWNED OR EQUIPPED WITH HEAVY EQUIPMENT SUCH AS BACKHOE BUCKETS. NO METHOD OF ROOT REMOVAL WILL BE DONE BY ANY METHOD THAT WOULD RESULT IN ANY DISPLACEMENT OF ROOTS THAT ARE TO REMAIN.
- THE MOVING PAY ITEM IN THIS PROJECT INCLUDES REMOVING LITTER AND DEBRIS FROM THE AREA AS TO BE MOVED PRIOR TO MOVING. ANY DEBRIS REMAINING IN MOVED AREAS SHALL BE REMOVED BY THE CONTRACTOR IMMEDIATELY AFTER MOVING AND THE MOVED AREA SHALL BE FREE OF LITTER AND DEBRIS IN ORDER FOR THE ENGINEER TO APPROVE PAYMENT OF THE MOVING WORK.
- TPOSSOL THICKNESS MAY VARY AT THE EDGE OF PAVEMENT TO THE INTO THE PAVEMENT GRADE.
- TACK COAT TO BE APPLIED ON DRIVEWAYS AS DIRECTED BY THE ENGINEER.
- THE CONTRACTOR SHALL BE REQUIRED TO CLEAR THE ENTIRE RIGHT OF WAY ON THE INSIDE AND OUTSIDE OF HORIZONTAL CURVES AS SHOWN ON THE PLAN SHEETS PRIOR TO BEGINNING ANY CLEARING OPERATIONS. THE PROJECT ENGINEER AND THE PROJECT SUPERINTENDENT SHALL SURVEY THE HORIZONTAL CURVES TO DETERMINE ANY SELECTED TREES THAT SHALL BE ALLOWED TO REMAIN IN PLACE. ANY TREES ALLOWED TO REMAIN IN PLACE SHALL BE AS DIRECTED BY THE ENGINEER.
- TO OBTAIN TO OBTAIN THE REQUIRED VERTICAL CLEARANCE SHALL BE A SUBSIDIARY OBLIGATION OF ITEM 20C - CLEARING. THE 20' MINIMUM VERTICAL CLEARANCE SHALL BE PRESENT AT THE TIME OF FINAL INSPECTION BY THE COUNTY OF MOBILE.

LEGEND

ABBREVIATIONS

ACT. ACTUAL
R/W RIGHT-OF-WAY

PLAN HATCHES

ASPHALT RESURFACING
PLANNING

SECTION HATCHES

EXISTING BASE
EXISTING ASPHALT
PROPOSED ASPHALT
PLANNING

LINE ITEMS

PROPOSED EDGE OF PAVEMENT
EXISTING EDGE OF PAVEMENT
EXISTING PROPERTY LINE
EXISTING RIGHT-OF-WAY
EXISTING EDGE OF PAVEMENT
MATCH LINE
LIMITS OF CONSTRUCTION

EXISTING

UTILITY POLE
STREET SIGN (TYP.)
ELECTRICAL MANHOLE
SAN SEWER MANHOLE
TELEPHONE MANHOLE
MANHOLE
WATER VALVE
WATER METER
GAS VALVE
GAS METER
GRATE INLET
BOX INLET W/ MANHOLE
FIRE HYDRANT
DOUBLE INLET
SINGLE INLET LEFT
SINGLE INLET RIGHT
PIPE CULVERT

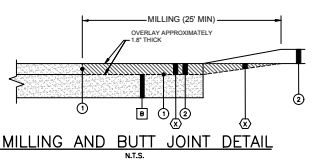
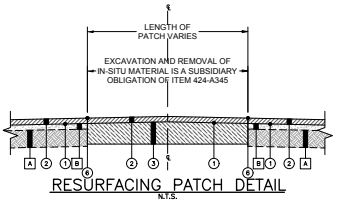
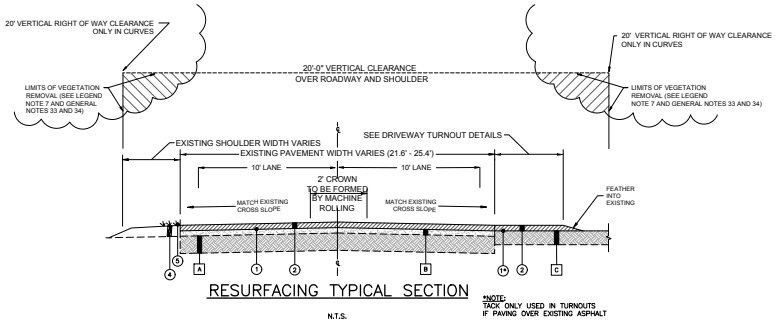

RESURFACING TYPICAL SECTION LEGEND

- EXISTING BASE MATERIAL
- EXISTING ASPHALT SURFACE
- EXISTING GRAVEL, DIRT, CONCRETE, OR ASPHALT DRIVEWAY
- TACK COAT
- SUPERPAVE BITUMINOUS CONCRETE WEARING SURFACE LAYER, 1 1/2" MAXIMUM AGGREGATE SIZE MAX. ESAL RANGE B - 200 (S1)
- SUPERPAVE BITUMINOUS CONCRETE WEARING SURFACE LAYER, PATCHING, 1" MAXIMUM AGGREGATE SIZE MAX. ESAL RANGE B - AS DIRECTED BY ENGINEER
- TPOSSOL, 4" COMPACTED THICKNESS (SEE SOD NOTE BELOW)
- SOLID SODDING (BERMUDA) 32" WIDE
- PLANNING EXISTING PAVEMENT (APPROXIMATELY 1.10" THRU 2.2" THICK) (SUBSIDIARY OBLIGATION)
- SAWCUT LINE (SUBSIDIARY OBLIGATION)
- REQUIRED LINING AND TRIMMING TO OBTAIN 20' MIN. VERTICAL CLEARANCE OVER ROADWAY AND SHOULDER CLEAR FROM ROW/FORW/ ONLY IN CURVES

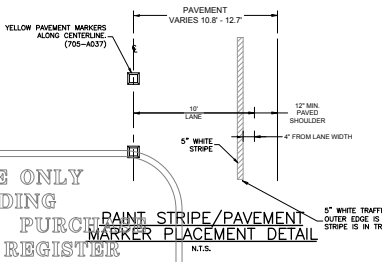

SOD NOTE

THE HEIGHT OF THE SOD SOIL MATRIX SHALL BE NO HIGHER THAN THE PAVEMENT FINISH SURFACE LEVEL AND NOT BE LESS THAN 2" BELOW THE TOP OF THE ASPHALT TO ALLOW FOR PAVEMENT DRAINAGE. ADJUST TPOSSOL THICKNESS TO ACHIEVE THIS HEIGHT.

REFERENCE ONLY
NOT FOR BIDDING
CONTRACTORS MUST PURCHASE PAINT STRIPE/PAVEMENT MARKER PLACEMENT DETAIL PLANS FROM AND REGISTER WITH THE ENGINEER TO BE ELIGIBLE TO BID

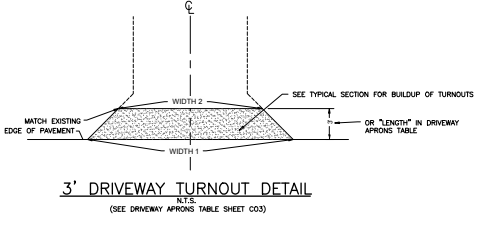
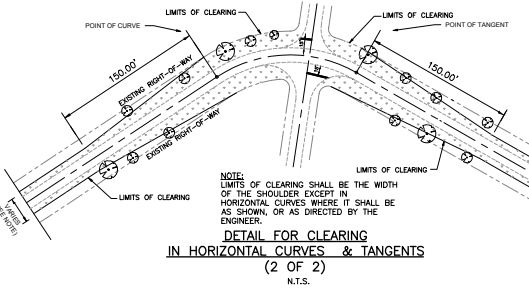
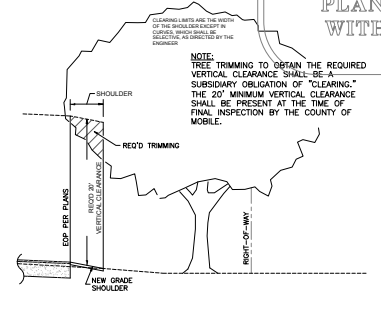

REV	DATE	DESCRIPTION
D	8/22/2019	ISSUED FOR BIDS
C	7/17/2019	100% SUBMITTAL
B	5/13/2019	80% SUBMITTAL FOR REVIEW
A	5/12/2019	50% SUBMITTAL FOR REVIEW

MOBILE COUNTY COMMISSION
MERCERIA L. LUDGOD
CONNIE HUDSON
JERRY CARL

Driven Engineering, Inc.
8005 Morris Hill Road
Semmes, AL 36575
(251) 649-4011 Office
(251) 645-9971 Fax
www.drivenengineering.com

MCR-2018-202
CITY OF SEMMES STREETS
LEGEND AND TYPICAL SECTIONS

DATE	03/22/2019	AS SHOWN
DRAWN BY	BN	CHECKED BY
DESIGNED BY	ALF	APPROVED BY
DRAWN ENGINEERING PROJECT NUMBER	19003	
DRAWING NUMBER	C02	SHEETS
	8	REVISION
		D

Copyright © as shown by Drive Engineering, Inc. All Rights Reserved.

PLANS NOT VALID UNLESS THEY BEAR A COLOR SIGNATURE OR AN IMPRESSED SOIL PLANS ARE NOT ISSUED FOR CONSTRUCTION UNLESS THE REVISION IS A NUMERAL.

DRIVEWAY APRON MEASUREMENTS

(SEE DETAIL ON SHEET C02)

Station	Width 1	Width 2	Length	Area
53+39	38.3	28.3	3	99.9
55+84	22.9	16.3	3	58.8
57+82	22.7	13.7	3	54.6
58+71	23.9	14.9	3	58.2
62+19	24.5	15.1	3	59.4
63+00	12	8	3	30
65+64	23.5	17.5	3	61.5
66+99	32.3	25.3	3	86.4
68+85	19	9	3	42
69+55	26.9	19.5	3	69.6
70+85	18.5	8.5	3	40.5
78+26	17	8	3	37.5
79+64	29.5	22.3	3	77.7
82+10	44.7	36.2	3	121.35
83+00	20.2	10.2	3	45.6
84+80	23.7	13.7	3	56.1
87+60	73	67	3	210
Kushla McLeod Road				
87+80	51.2	45.2	3	144.6
89+13	24.3	21.3	3	68.4
91+91	24.1	16.1	3	60.3
99+52	25	19	3	66
102+34	22.2	16.2	3	57.6
106+08	25	19	3	66
106+12	30.4	22.4	3	79.2
124+06	25.7	19.7	3	68.1
124+83	24.9	16.6	3	62.25
131+78	93.9	83.9	3	266.7
133+72	56	46	3	153
141+26	28.5	22.2	3	76.05
149+77	38.5	32.5	3	106.5
		Rosemary Total:		1209.15
		Kushla McLeod Total:		1274.7
		Total Area(sqft):		2483.85

SUMMARY OF QUANTITIES

PROJECT TOTAL	Rosemary Road	Kushla-McLeod Road	ITEM NUMBER	UNIT	DESCRIPTION
1.00	0.50	0.50	201-C000	LS	CLEARING
195.00	70.00	125.00	212-A000	STA	MACHINE GRADING OF SHOULDERS
2,550.00	950.00	1,600.00	405-A000	GAL	TACK COAT
2,550.00	950.00	1,600.00	424-A340	TON	SUPERPAVE BITUMINOUS CONCRETE WEARING SURFACE LAYER, 1/2" MAXIMUM AGGREGATE SIZE MIX, ESAL RANGE A/B (200#/SY)
50.00	25.00	25.00	424-A345	TON	SUPERPAVE BITUMINOUS CONCRETE WEARING SURFACE LAYER, PATCHING, 1" MAXIMUM AGGREGATE SIZE MIX, ESAL RANGE A/B
1.00	0.50	0.50	600-A000	LS	MOBILIZATION
1,000.00	350.00	650.00	650-A000	CYIP	TOPSOIL (4" COMPACTED THICKNESS) (LOOSE TRUCKBED MEASUREMENT)
2.00	1.00	1.00	652-A100	AC	SEEDING
2.00	1.00	1.00	652-C000	AC	MOWING
5,900.00	2,100.00	3,800.00	654-A000	SY	SOLID SODDING
2.00	1.00	1.00	656-A010	AC	MULCHING
0.00	0.00	0.00	698-A000	LS	CONSTRUCTION FUEL (MAXIMUM BID LIMITED TO \$2,000)
5.00	2.00	3.00	701-A227	MILES	SOLID WHITE, CLASS 2, TYPE A TRAFFIC STRIPE (5" WIDE)
5.00	2.00	3.00	701-A230	MILES	SOLID YELLOW, CLASS 2, TYPE A TRAFFIC STRIPE (5" WIDE)
1.00	0.00	1.00	701-A244	MILES	BROKEN YELLOW, CLASS 2, TYPE A TRAFFIC STRIPE (5" WIDE)
8.00	3.00	5.00	701-C003	MILES	SOLID TEMPORARY TRAFFIC STRIPE (PAINT)
208.00	75.00	133.00	705-A037	EA	PAVEMENT MARKERS, CLASS A-III, TYPE 2-D
7.00	3.00	4.00	705-A038	EA	PAVEMENT MARKERS, CLASS A-III, FIRE HYDRANT 2-SIDED BLUE MARKERS
264.00	132.00	132.00	740-B000	SF	CONSTRUCTION SIGNS
50.00	25.00	25.00	740-D000	EA	CHANNELIZING DRUMS
50.00	25.00	25.00	740-E000	EA	CONES (36" HIGH)
50.00	25.00	25.00	740-M001	EA	BALLAST FOR CONE
1.00	0.50	0.50	740-O001	LS	PILOT CAR

RAISED PAVEMENT MARKER LOCATIONS

ROSEMARY ROAD	
53+00 - 88+00	75 Yellow Centerline
58+15	Blue Hydrant Marker
67+20	Blue Hydrant Marker
82+40	Blue Hydrant Marker
KUSHLA-MCLEOD ROAD	
88+00 - 151+50	133 Yellow Centerline
88+30	Blue Hydrant Marker
104+40	Blue Hydrant Marker
121+50	Blue Hydrant Marker
134+80	Blue Hydrant Marker
* Blue Hydrant Marker Locations are approximate.	
Markers must be removed and replaced in center of lane that matches the side of corresponding fire hydrant.	

FOR REFERENCE ONLY
NOT FOR BIDDING
CONTRACTORS MUST PURCHASE
PLANS FROM AND REGISTER
WITH THE ENGINEER TO BE
ELIGIBLE TO BID

PLANS NOT VALID UNLESS THEY BEAR A COLOR SIGNATURE OR AN IMPRESSED SEAL. PLANS ARE NOT ISSUED FOR CONSTRUCTION UNLESS THE REVISION IS A NUMBER.

DATE	BY	REVISION
D	8/22/2019	ISSUED FOR BIDS
C	7/17/2019	100% SUBMITTAL
B	5/4/2019	90% SUBMITTAL FOR REVIEW
A	5/12/2019	50% SUBMITTAL FOR REVIEW

MOBILE COUNTY COMMISSION
MERCERIA L. LUGOOD
CONNIE HUDSON
JERRY CARL



Driven Engineering, Inc.
8005 Morris Hill Road (251) 649-4011 Office
Semmes, AL 36575 (251) 645-5971 Fax
www.driveneengineering.com

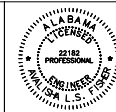

MCR-2018-202		CITY OF SEMMES STREETS		SUMMARY OF QUANTITIES	
DATE	03/22/2019	ISSUED BY	AS SHOWN	DATE	03/22/2019
DRAWN BY	ES	CHECKED BY	ALF	APPROVED BY	ALF
DRAWING NUMBER	C03	PROJECT NUMBER	19003	DRAWING NUMBER	C03
TOTAL SHEETS	8	REVISION	D		

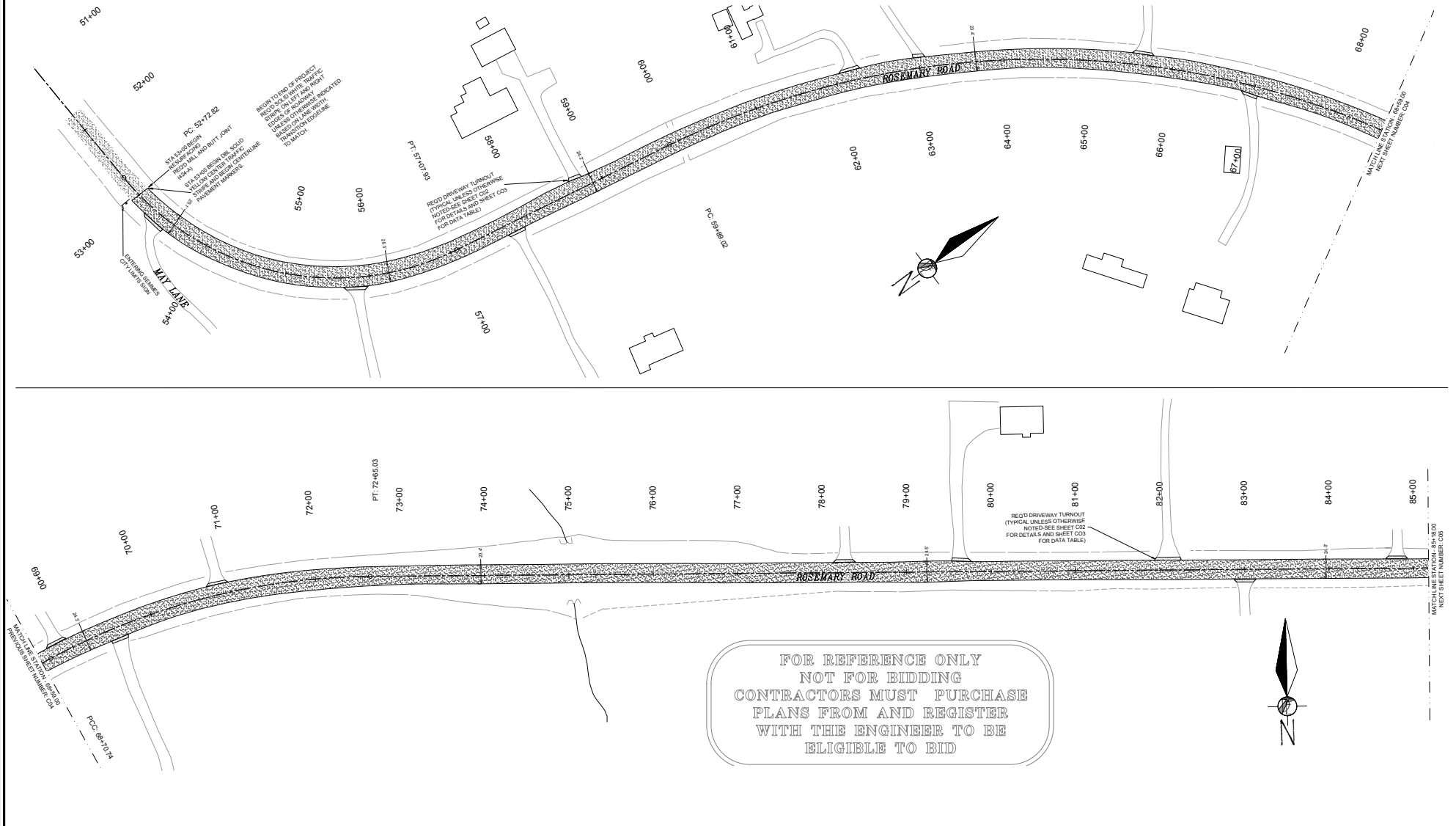

FOR REFERENCE ONLY
 NOT FOR BIDDING
 CONTRACTORS MUST PURCHASE
 PLANS FROM AND REGISTER
 WITH THE ENGINEER TO BE
 ELIGIBLE TO BID

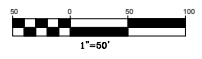

PLANS NOT HELD UNLESS THEY BEAR A COLOR SIGNATURE OR AN IMPRESSED SEAL. PLANS ARE NOT ISSUED FOR CONSTRUCTION UNLESS THE REVISION IS A NUMBER.

DATE	BY	CHKD	APP'D
8/22/2019	ALF	ALF	ALF
7/17/2019	BN	ALF	ALF
54/23/2018	BN	ALF	ALF
53/22/2018	BN	ALF	ALF
53/22/2018	BN	ALF	ALF

MOBILE COUNTY COMMISSION
 MERCERIA L. LUDGOOD
 CONNIE HUDSON
 JERRY CARL

Driven Engineering, Inc.
 8005 Morris Hill Road (251) 649-4011 Office
 Semmes, AL 36575 (251) 645-5971 Fax
 www.drivenengineering.com

MCR-2018-202
 CITY OF SEMMES STREETS
 ROSEMARY AND KUSHLA-MCLEOD ROAD PLAN
 1 OF 3

DATE	ISSUED	AS SHOWN
03/22/2019	BN	ALF
DATE	ISSUED	AS SHOWN
03/22/2019	BN	ALF
DATE	ISSUED	AS SHOWN
03/22/2019	BN	ALF

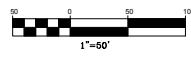
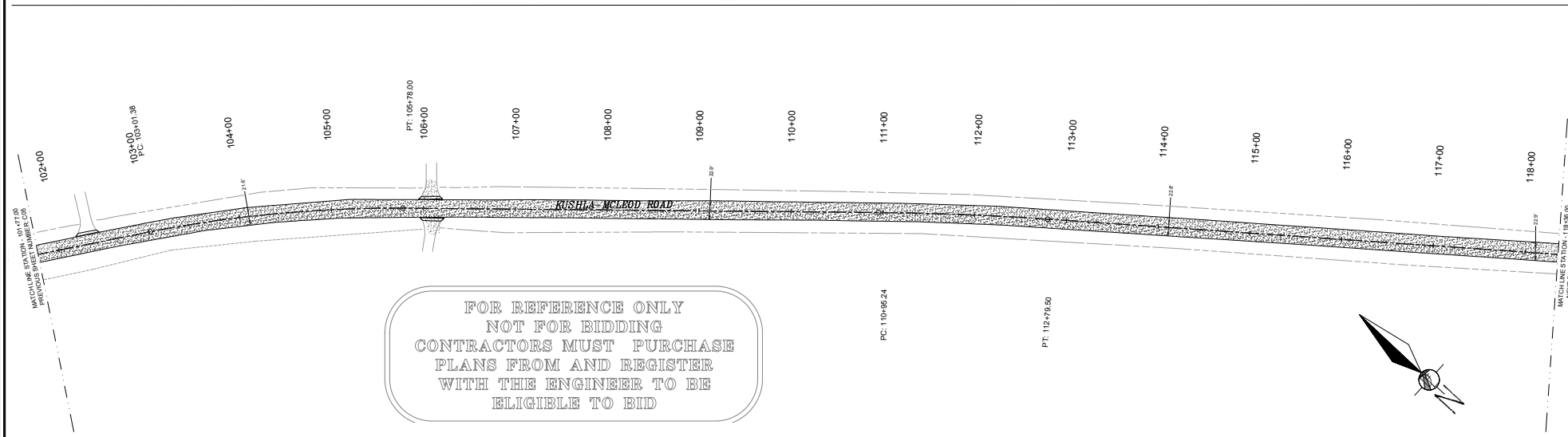

PLANS NOT HELD UNLESS THEY BEAR A COLOR SIGNATURE OR AN IMPRESSED SEAL. PLANS ARE NOT GOOD FOR CONSTRUCTION UNLESS THE REVISION IS A NUMBER.

NO.	DATE	BY	CHKD	APP'D	REVISION
D	8/22/20	ALF	ALF	ALF	ISSUED FOR BIDS
C	7/17/2018	ME	ALF	ALF	100% COMPLETE
B	5/13/2018	ME	ALF	ALF	80% SUBMITTAL FOR REVIEW
A	5/12/2018	ME	ALF	ALF	50% SUBMITTAL FOR REVIEW

MOBILE COUNTY COMMISSION

MERCERIA L. LUGOOD
CONNIE HUDSON
JERRY CARL

Driven Engineering, Inc.

8005 Morris Hill Road (251) 649-4011 Office
Semmes, AL 36575 (251) 645-5971 Fax
www.driveneengineering.com



MCR-2018-202
CITY OF SEMMES STREETS
ROSEMARY AND KUSHLA-MCLEOD ROAD PLAN
2 OF 3

DATE	ISSUED BY	AS SHOWN
03/22/2019	ALF	ALF
03/22/2019	ALF	ALF
03/22/2019	ALF	ALF

DRIVEN ENGINEERING PROJECT NUMBER: 19003

DRAWING NUMBER	TOTAL SHEETS	REVISION
C05	8	D

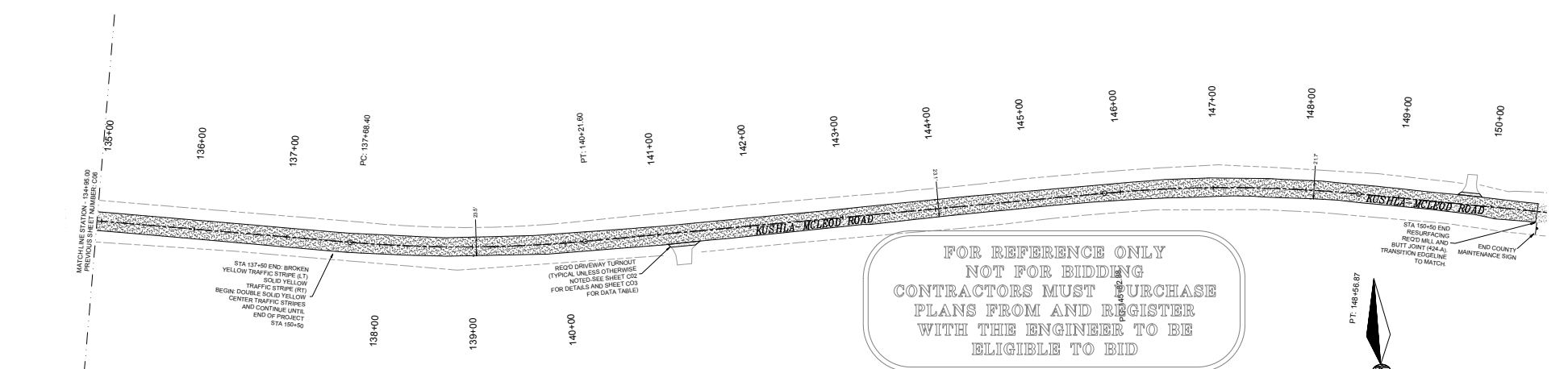
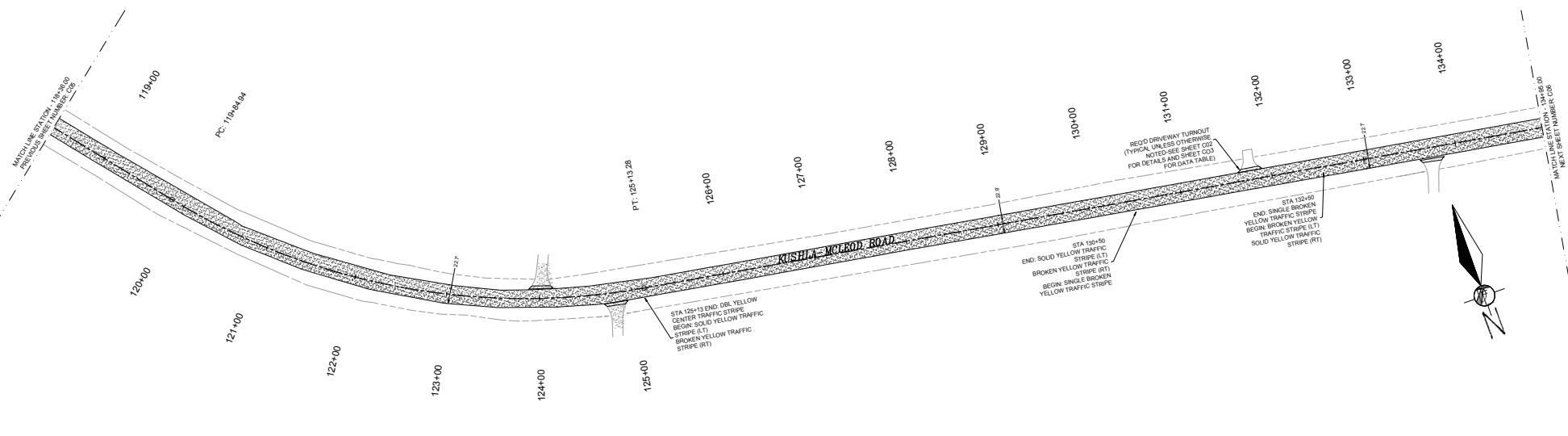

**FOR REFERENCE ONLY
NOT FOR BIDDING
CONTRACTORS MUST PURCHASE
PLANS FROM AND REGISTER
WITH THE ENGINEER TO BE
ELIGIBLE TO BID**

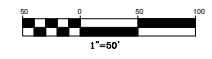

PLANS NOT VALID UNLESS THEY BEAR A COLOR SIGNATURE OR AN IMPRESSED SEAL. PLANS ARE NOT ISSUED FOR CONSTRUCTION UNLESS THE REVISION IS A NUMBER.

NO.	DATE	BY	CHKD	APP'D	REVISION
D	8/22/2019	ALF	ALF	ALF	ISSUED FOR BIDS
C	7/17/2019	ALF	ALF	ALF	100% SUBMITTAL
B	54/23/2018	ALF	ALF	ALF	90% SUBMITTAL FOR REVIEW
A	5/12/2018	ALF	ALF	ALF	50% SUBMITTAL FOR REVIEW

MOBILE COUNTY COMMISSION

MERCERIA L. LUGOOD
CONNIE HUDSON
JERRY CARL

Driven Engineering, Inc.

8005 Morris Hill Road (251) 649-4011 Office
Semmes, AL 36575 (251) 645-5971 Fax
www.driveneengineering.com



MCR-2018-202
CITY OF SEMMES STREETS
ROSEMARY AND KUSHLA-MCLEOD ROAD PLAN
3 OF 3

Copyright © as Issued by Driven Engineering, Inc. All Rights Reserved

DATE	ISSUED BY	AS SHOWN BY
03/22/2019	ALF	ALF
03/22/2019	ALF	ALF

DRAWN ENGINEERING PROJECT NUMBER: 19003
DRAWING NUMBER: C06
TOTAL SHEETS: 8
REVISION: D

SUMMARY OF SIGNS				
SIGN	SIGN DESCRIPTION	SF	QUANTITY	TOTAL SF
W20-1	ROAD WORK AHEAD	16	2	32
W20-1	ROAD WORK 500 FT	16	4	64
W20-1	ROAD WORK 1000 FT	16	4	64
W20-4	ONE LANE ROAD 500 FT	16	2	32
W20-7A	FLAGGER AHEAD	16	2	32
G20-2	END ROAD WORK	10	4	40
TOTAL SIGNAGE (ALL ROADS)				264

SUMMARY OF QUANTITIES		
QUANTITY	UNIT	ITEM DESCRIPTION
264	SF	CONSTRUCTION SIGNS TYPE IV (740-B)
0	EACH	WARNING LIGHTS, TYPE B
1	EACH	PROJECT SIGNS (NOT A PAY ITEM)
1	EACH	PILOT CAR (740-0)
50	EACH	CHANNELIZING DRUMS (740-D)
50	EACH	CONES (36 INCHES HIGH) (740-E)

CONSTRUCTION SIGN LEGEND

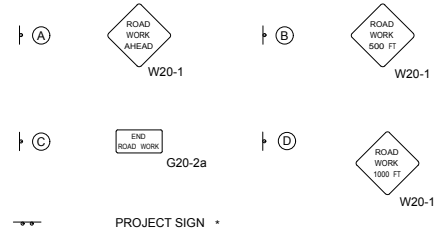

* NOTE: THE PROJECT SIGN WILL BE INSTALLED IN THE FIELD IN AN AREA APPROVED BY THE ENGINEER.
 NOTE: WARNING LIGHTS, SHOWN IN THIS DETAIL ARE A SUBSIDIARY OBLIGATION OF EACH PARTICULAR ROAD SIGN.

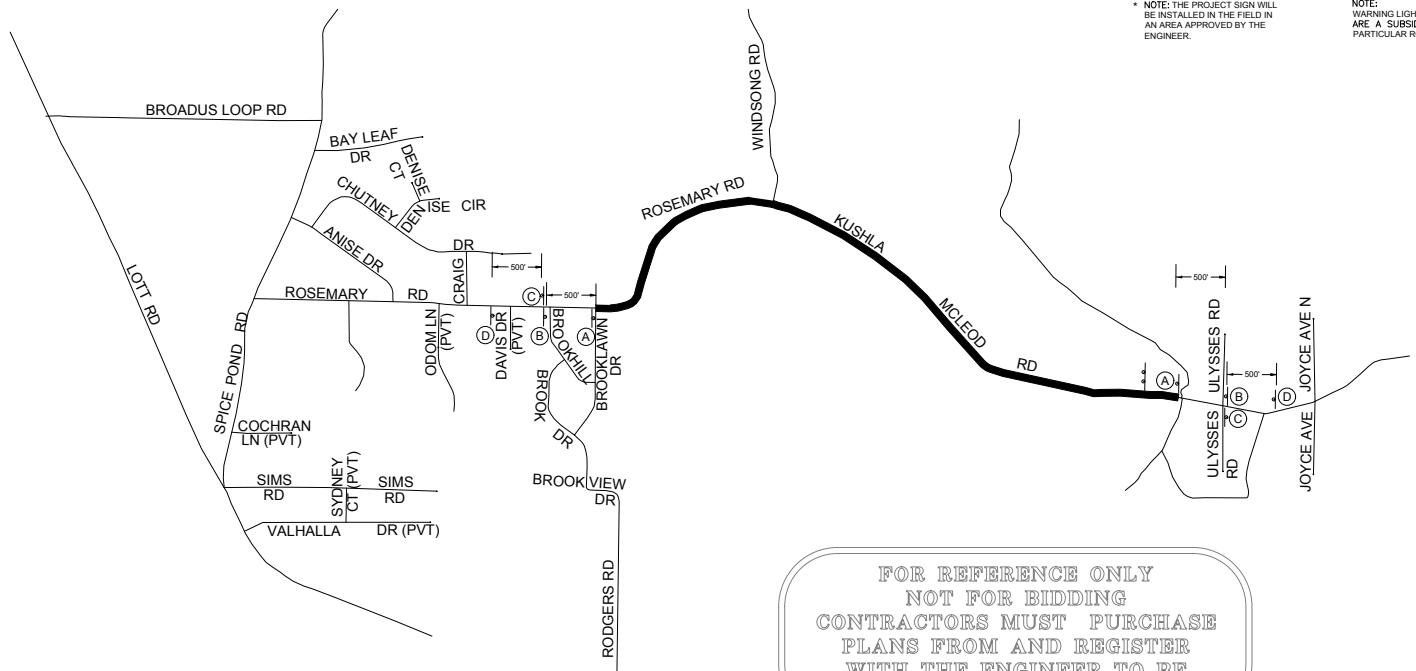

FOR REFERENCE ONLY
 NOT FOR BIDDING
 CONTRACTORS MUST PURCHASE
 PLANS FROM AND REGISTER
 WITH THE ENGINEER TO BE
 ELIGIBLE TO BID



(PROPOSED WORK AREA)
 DRAWING N.T.S.

PLANS NOT VALID UNLESS THEY BEAR A COLOR SIGNATURE OR AN IMPRESSED SEAL. PLANS ARE NOT ISSUED FOR CONSTRUCTION UNLESS THE REVISION IS A NUMBER.

NO.	DATE	BY	FOR
D	8/22/2019	ALF	ALF
C	7/17/2019	ALF	ALF
B	5/13/2018	ALF	ALF
A	5/12/2018	ALF	ALF

MOBILE COUNTY COMMISSION
 MERCERIA L. LUDGOOD
 CONNIE HUDSON
 JERRY CARL

Driven Engineering, Inc.
 8005 Morris Hill Road Semmes, AL 36575
 (251) 649-4011 Office
 (251) 645-5971 Fax
 www.drivenengineering.com

MCR-2018-202
 CITY OF SEMMES STREETS
 TRAFFIC CONTROL PLAN

DATE	ISSUE	AS SHOWN
03/22/2019	ALF	ALF
03/22/2019	ALF	ALF
03/22/2019	ALF	ALF

DRIVEN ENGINEERING PROJECT NUMBER: 19003
 DRAWING NUMBER: C07
 TOTAL SHEETS: 8
 REVISION: D

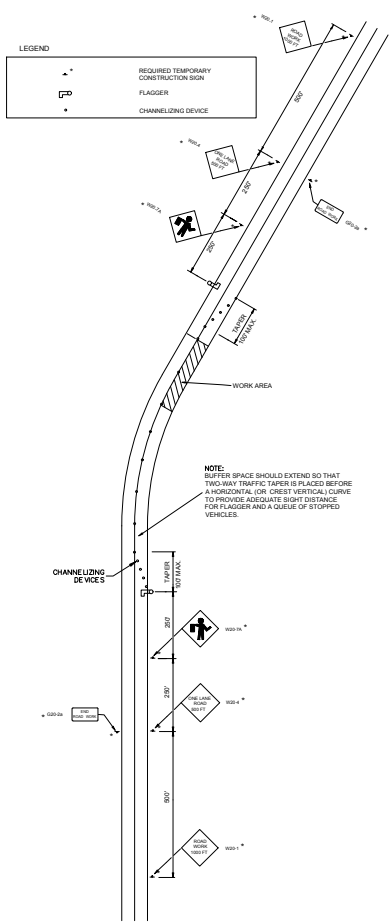

TEMPORARY ONE-LANE CLOSURE DETAIL
NOT TO SCALE

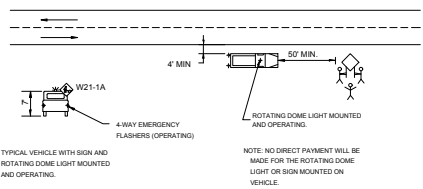

TYPICAL METHOD FOR PLACEMENT OR REMOVAL OF CONSTRUCTION SIGNS

FOR REFERENCE ONLY
NOT FOR BIDDING
CONTRACTORS MUST PURCHASE
PLANS FROM AND REGISTER
WITH THE ENGINEER TO BE
ELIGIBLE TO BID

TRAFFIC CONTROL NOTES

- 701 THE TRAFFIC CONTROL PLAN IS DEVELOPED IN CONFORMANCE WITH THE MANUAL ON UNIFORM TRAFFIC CONTROL DEVICES, PART VI, CURRENT EDITION. THE TRAFFIC CONTROL DEVICES INDICATED REPRESENT CONDITIONS KNOWN DURING PLAN DEVELOPMENT. IN THE EVENT ACTUAL CONDITIONS WARRANT ADDITIONAL TRAFFIC CONTROL DEVICES, THE SAME SHALL BE INSTALLED IN CONFORMANCE WITH THE CONTRACTOR SHALL PLACE ALL ADVANCE WARNING SIGNS BEFORE PROCEEDING WITH HIS WORK. SIGNS SHALL BE PLACED IN ORDER IN THE DIRECTION OF TRAFFIC AND REMOVED IN REVERSE ORDER.
- 702 THE CONTRACTOR SHALL PLACE ALL ADVANCE WARNING SIGNS BEFORE PROCEEDING WITH HIS WORK. SIGNS SHALL BE PLACED IN ORDER IN THE DIRECTION OF TRAFFIC AND REMOVED IN REVERSE ORDER.
- 703 ANY SIGNING OR OTHER TRAFFIC CONTROL DEVICES NOT SHOWN ON THIS TOP BUT DEEMED NECESSARY BY THE ENGINEER SHALL BE FURNISHED BY THE CONTRACTOR AND PAID FOR UNDER THE APPROPRIATE PAY ITEM.
- 704 DURING NONWORKING HOURS, NO EQUIPMENT OR MATERIAL SHALL BE PARKED OR STORED CLOSER THAN 30 FEET TO THE EDGE OF ANY ROADWAY CARRYING TRAFFIC. WHEN THIS IS NOT PRACTICAL, IT SHALL BE PLACED IN AN AREA DESIGNATED BY THE ENGINEER AND DELIMITED BY REFLECTORIZED DRUMS AND WARNING LIGHTS. THIS INCLUDES STORAGE OF TRAFFIC CONTROL DEVICES SUCH AS TRAILER MOUNTED OR TEMPORARY SIGNS, BARRICADES, DRUMS, ETC., WHICH ARE NOT IN USE DURING NONWORKING HOURS.
- 705 THE CONTRACTOR SHALL MAINTAIN AT LEAST ONE ACCESS TO BUSINESSES AND RESIDENCES DURING ALL PHASES OF CONSTRUCTION. THE CONTRACTOR MAY EXECUTE AS MANY OPERATIONS OF CONSTRUCTION SIMULTANEOUSLY AS HE CAN SAFELY AND EFFICIENTLY HANDLE WITH THE APPROVAL OF THE ENGINEER.
- 707 THE CONTRACTOR WILL BE PERMITTED TO DEVELOP THEIR OWN TRAFFIC CONTROL PLAN TO BE USED IN LIEU OF THIS TRAFFIC CONTROL PLAN. THE PLAN MUST BE APPROVED BY THE ENGINEER.
- 708 THE CONTRACTOR SHALL NOT BE ALLOWED TO LEAVE AN OPEN CUTS ADJACENT TO ANY TRAVELED WAY DURING NONWORKING HOURS.
- 709 FLAGGERS SHALL BE PROPERLY EQUIPPED, ATTIRED, AND IN SIGHT OF, OR IN RADIO CONTACT WITH EACH OTHER AT ALL TIMES.
- 710 WHERE FLAGGERS ARE REQUIRED, STAFF MOUNTED STOP-SLOW PADDLES SHALL BE UTILIZED.
- 711 NOT USED.
- 712 ALL REQUIRED CONSTRUCTION SIGNS MOUNTED ON TEMPORARY SUPPORTS ARE TO BE REMOVED OR COVERED AT THE COMPLETION OF THE DAY'S OPERATION OR WHEN NO WORK IS BEING PERFORMED.
- 713 ALL SIGN SUPPORTS SHALL COMPLY WITH STANDARD DRAWING TCD108.
- 714 ALL CONSTRUCTION SIGN LIGHTING SHALL COMPLY WITH SPECIAL DRAWING LGS107.
- 715 ALL SIGNS SHALL MEET MUTL E.D., PART V, CURRENT EDITION, TYPE 'B' STANDARDS. ALL CHANNELING DRUMS SHALL BE TYPE 'B'.
- 716 DO NOT BLOCK VIEW OF STOP SIGNS OR ANY OTHER PERMANENT SIGN, WITH PROJECT SIGNS OR ANY OTHER TRAFFIC CONTROL DEVICE.
- 717 A REFLECTORIZED DRUM SHALL BE PLACED IN FRONT OF EACH CONSTRUCTION SIGN THAT IS STORED ON THE SHOULDER AT ANY TIME DURING THE COURSE OF THE PROJECT, INCLUDING BUT NOT LIMITED TO COVERED SIGNS AND TEMPORARY MOUNTED SIGNS THAT HAVE BEEN LAD OVER. THE COST OF THIS REQUIREMENT SHALL BE A SUBSIDIARY OBLIGATION OF ITEM #168-000 (CONSTRUCTION SIGNS) WHEN A PAY ITEM FOR CHANNELING DRUMS IS NOT PROVIDED IN THE PLANS.

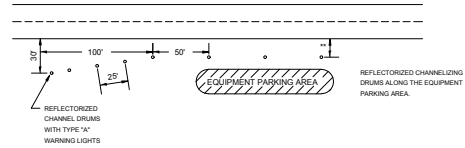

DELINEATING DETAILS FOR EQUIPMENT PARKING AREAS

*DRUMS TO BE AS FAR AS PRACTICAL FROM EDGE OF PAVEMENT. MINIMUM DESIRABLE DISTANCE IS 15 FEET FOR FREEWAY TYPE FACILITIES AND 10 FEET FOR OTHER FACILITIES. FOR UNUSUAL CONDITIONS, SUCH AS SPECIAL EQUIPMENT OR LIMITED AVAILABLE SPACE, DIMENSIONS LESS THAN DESIRABLE SHALL BE AS DIRECTED BY THE ENGINEER. (TO BE FURNISHED BY THE CONTRACTOR WITHOUT COST TO THE COUNTY.)

(FOR USE ONLY WHEN EQUIPMENT CANNOT BE STORED THIRTY FEET OR MORE FROM THE EDGE OF PAVEMENT.)

PLANS NOT VALID UNLESS THEY BEAR A COLOR SIGNATURE OR AN IMPRESSED SEAL. PLANS NOT ISSUED FOR CONSTRUCTION UNLESS THE REVISION IS A NUMBER.

REV	DATE	BY	CHKD	APP'D	DESCRIPTION
D	8/22/2018	ALF	ALF	ALF	ISSUED FOR BIDS
C	7/17/2018	ALF	ALF	ALF	100% SUBMITTAL
B	54/23/2018	ALF	ALF	ALF	80% SUBMITTAL FOR REVIEW
A	53/22/2018	ALF	ALF	ALF	50% SUBMITTAL FOR REVIEW

MOBILE COUNTY COMMISSION
MERCERIA L. LUGGOOD
CONNIE HUDSON
JERRY CARL



Driven Engineering, Inc.
8005 Morris Hill Road (251) 649-4011 Office
Semmes, AL 36575 (251) 645-5971 Fax
www.driveneengineering.com



MOBILE COUNTY ALABAMA
22182
PROFESSIONAL
ENGINEER
SEAL
JERRY CARL
L.S. 1000000000

MCR-2018-202
CITY OF SEMMES STREETS
TRAFFIC CONTROL DETAIL SHEET

DATE	03/22/2019	ISSUED BY	ALF	AS SHOWN	ALF
DRAWN BY	BN	CHECKED BY	ALF	APPROVED BY	ALF
DRAWN ENGINEERING PROJECT NUMBER	19003				
DRAWING NUMBER	C08	SHEET	8	REVISION	D

Copyright © as Issued by Driven Engineering, Inc.
All Rights Reserved